



Time Travel with Abhishek



Art and Culture

Abhishek Srivastava



**TIME
TRAVEL**



Abhishek Srivastava

- Sr. Academic Advisory, Unacademy
- Ex-Director [UPSC CSE], Unacademy
- Teaching Exp. - 7 Year +
- *Join Time Travel Batches for complete History preparation*
- *Telegram Channel for free content - <https://t.me/abhishekunacademy>*

Ultimate Coverage of Indian History & Culture

#crackupsc

"TT100"
Use code for discount

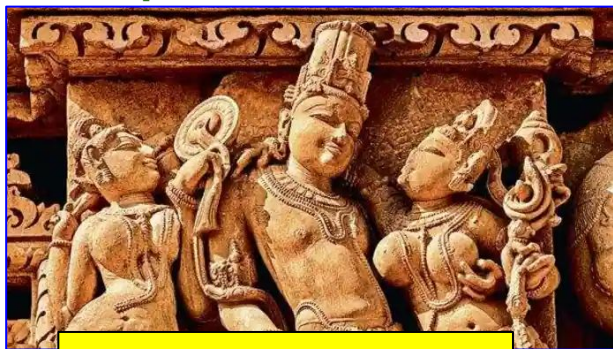

Ancient Indian History

[Click here](#)



Medieval Indian History

[Click here](#)



Modern Indian History

[Click here](#)

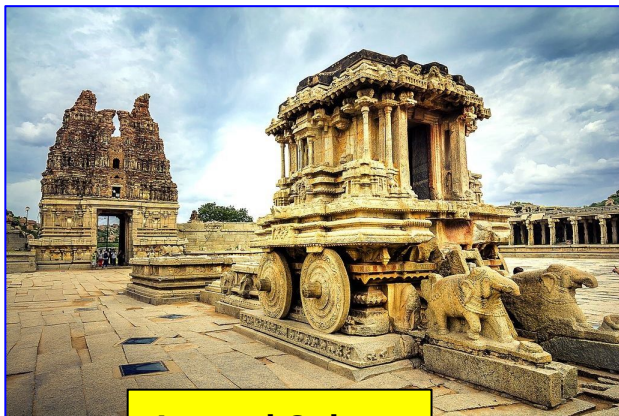

Art and Culture

[Click here](#)

- **Exhaustive coverage** for Prelims & Mains
- Explanation via **Timelines** and **Maps**
- **Logic** and Philosophy discussed
- **Previous Years** Questions incorporated
- **One-stop PDF solutions**
- **Mains Answer Writing Discussion**
- **Prelims Practice sets**



Abhishek Srivastava

Top Educator, Unacademy

Dial

“TT100”



**MODERN
ARCHITECTURE**



Overview

The arrival of the European colonists coincided with the decline of the Mughal empire which started a power struggle among the **Portuguese, French, Dutch, Danish and the British** which culminated into British rule till 1947.

However, the Europeans also brought with them a wealth of architectural styles, which can be seen in the numerous constructions they undertook. Some prominent architectural styles emerged during this period were **Romanesque, Gothic, Renaissance, and Neo-Classical.**



Romanesque

- architectural style of **medieval Europe** characterized by **semi-circular arches**.
- It emerged in the **6th century** and **later in the 12th century** it developed into the Gothic style, marked by pointed arches.
- **Characteristics of Romanesque**
 - Massive quality, thick walls,
 - round arches,
 - sturdy pillars,
 - barrel vaults,
 - large towers
 - decorative arcading.
 - Each building has clearly defined forms, frequently of very regular, symmetrical plan.



Maria Laach, Germany



Stephens Church, Delhi

Gothic

- It was prevalent in Europe from the late **12th to the 18th century**.
- It evolved from Romanesque architecture and was succeeded by Renaissance architecture.
- Characteristics
 - The most significant feature of Gothic architecture is its height.
 - The **pointed or ogival arch**.
 - The use of the pointed arch in turn led to the development of the **pointed rib vault** and flying buttresses, combined with elaborate tracery and stained glass windows.



Wells Cathedral, England

All saints' Cathedral, Allahabad

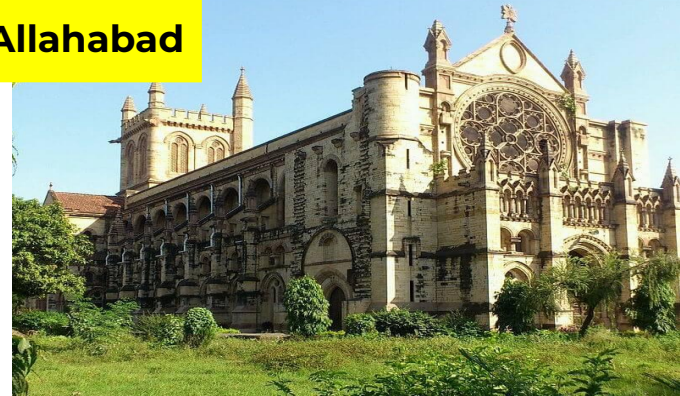

Saint Peter's Basilica, Rome



Renaissance

- Renaissance architecture originated in **Italy** and superseded the Gothic style over a period generally defined as **1400 to 1600**.
- **Characteristics**
 - Use of the classical orders and mathematically precise ratios of height and width
 - desire for symmetry, proportion, and harmony.
 - Columns, pediments, arches and domes are imaginatively used in buildings of all types.



Victoria Palace, Kolkata

Neoclassical Architecture

- style of buildings constructed during the revival of Classical Greek and Roman architecture
- began around 1750
- flourished in the **18th and 19th centuries.**

- Neoclassical buildings are characterized by the use of:
 - Grand scale volumes
 - Simple geometric forms
 - Dramatic columns
 - Doric Greek or Roman detailing
 - Domed or flat roofs, depending on style

- Examples:
 - The Pantheon in Paris
 - Museo Nacional del Prado in Madrid.



**Museo Nacional del Prado,
Madrid**

The Pantheon in Paris



Town Hall, Mumbai



European settlements in India (1498 - 1739)

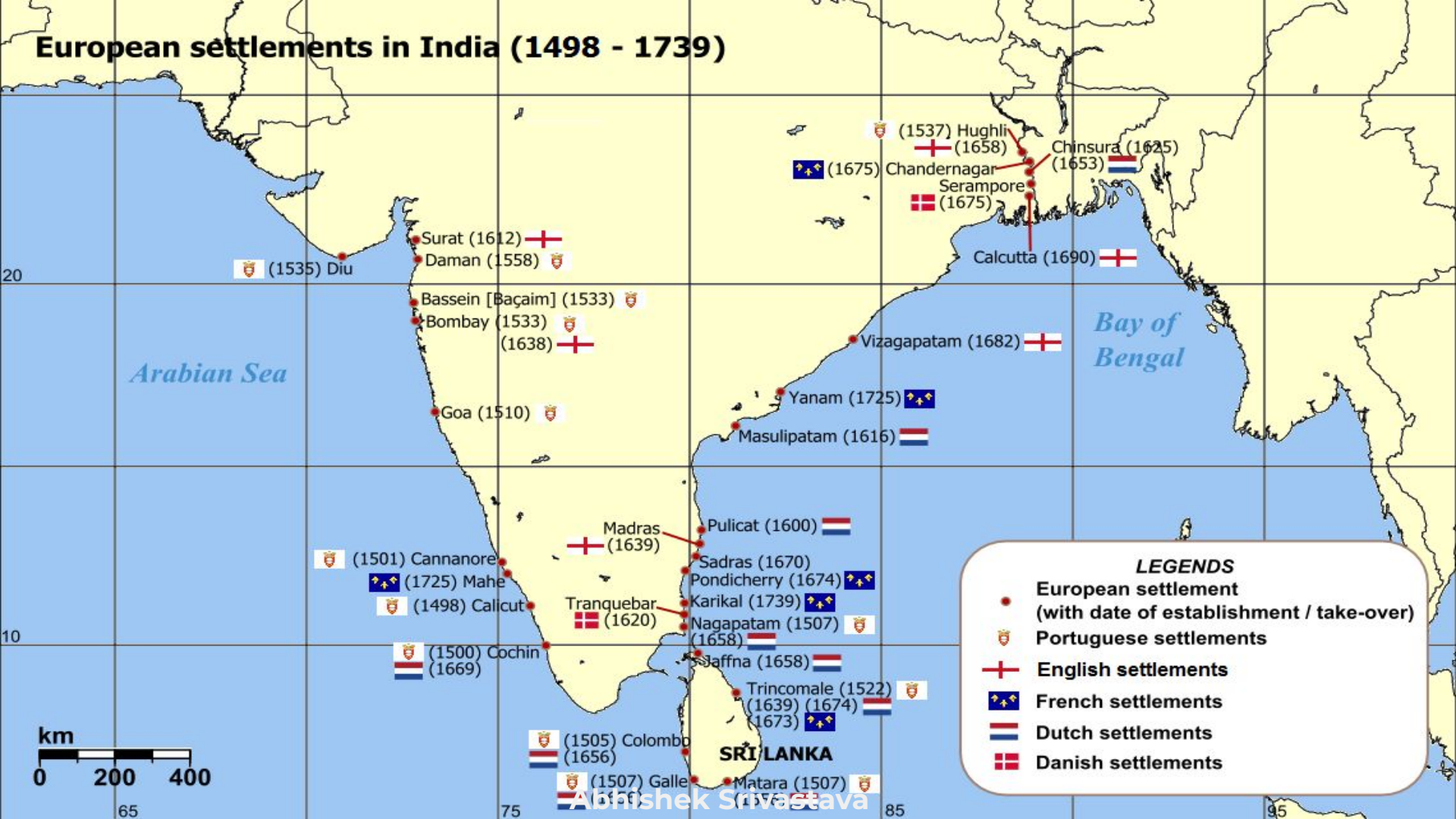

LEGENDS

- European settlement (with date of establishment / take-over)
- 🇵🇹 Portuguese settlements
- 🇬🇧 English settlements
- 🇫🇷 French settlements
- 🇳🇱 Dutch settlements
- 🇩🇰 Danish settlements

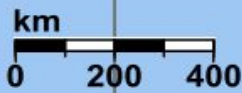

Portuguese Architecture

- The Portuguese brought with them the **Iberian style of architecture**.
- They initially built trading posts and ware houses, which were later remodelled into fortified towns along the coastlines.
- They also introduced the concept of '**Patio houses**' and '**Baroque style**' developed in late 16th century in Europe to express the strength of the Church.
 - A **patio home** is a dwelling that shares at least one wall with another home, and usually doesn't rise higher than one and-a-half stories tall.
 - The **Baroque style** is characterized by exaggerated motion and clear detail used to produce drama, exuberance, and grandeur in sculpture, painting, architecture, literature, dance, and music. It is applied in church to express the strength of the church.
 - It involved use of **contrasting colours** and elaborate, detailed and theatrical design to create a dramatic effect.



St. Francis Church at Cochin, Kerala

It built in 1510. It is the first church built by European in India.

Iberian style- refers to the art of Spain and Portugal after the Classical Age and before Romanesque art and architecture

Basilica of Bom Jesus, Goa

1604

(Baroque style)

UNESCO World Heritage Site
It has the body of revered St.
Francis Xavier.



Se Cathedral, Goa (late-gothic)

built in 1619 to commemorate the victory
of the Portuguese under Afonso de
Albuquerque over a Muslim army. It has a
large bell called "Golden Bell".





Arch of Conception of Goa
built on the theme of Portuguese-Gothic
style

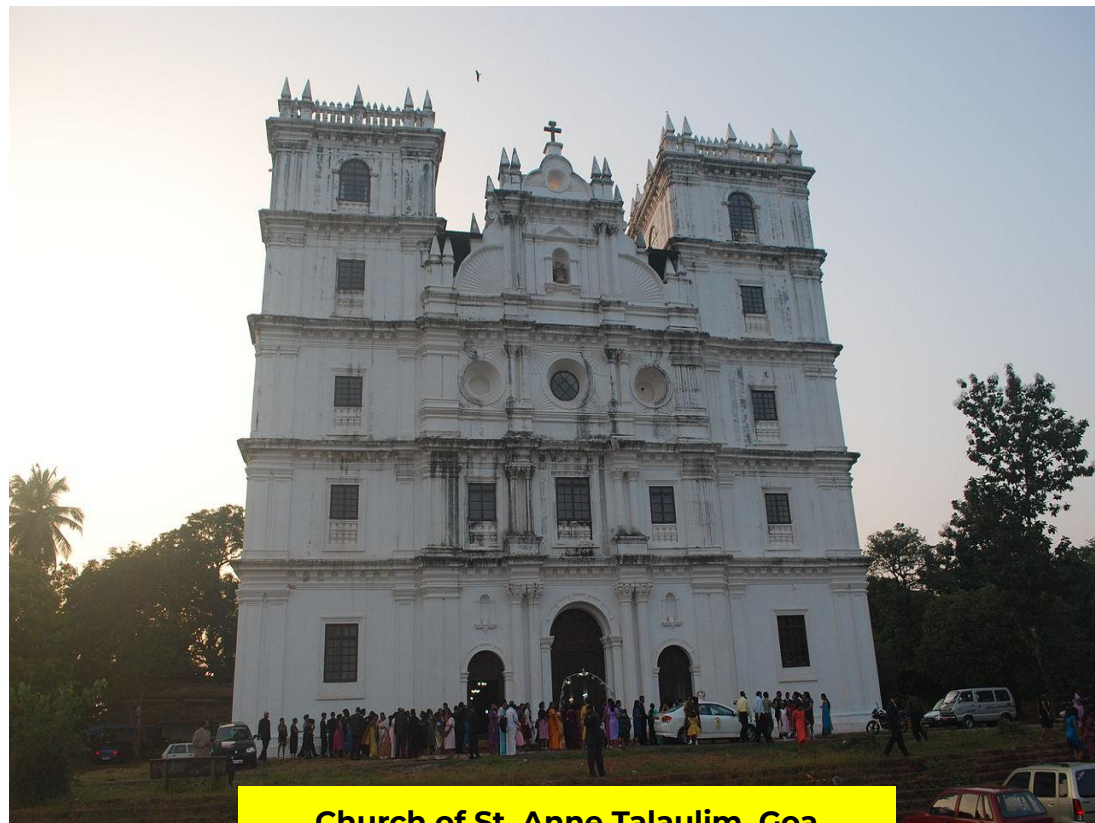

Church of St. Anne Talaulim, Goa
major example of the colonial Portuguese
Baroque architecture built in Portuguese
India.

Castella de Aguada in Mumbai



St. Paul's Church, Diu

It is built in Baroque style and was completed in 1610 AD.



Bassein Fort (Vesai Fort)

- It was fortified by Bahadur Shah of Gujarat in 1532 AD.
- It is famous for ***Corinthian pillared hall*** and the Porte da Mer (The sea gate).
- It is also popular for cathedral of St. Joseph.



Lighthouse of Diu



Diu Fort

- It was built in 1535 AD on the coast of Diu island.
- The fort has a lighthouse and canons are placed on the walls. It has three churches inside the fort complex namely: St. Thomas Church, St. Paul's Church, and Church of St. Francis of Assisi.



French Architecture

- The French brought the concept of urban city planning with them.
- The French towns of Puducherry and Chandernagore (now Chandannagar, West Bengal) were built using the **Cartesian grid plans and scientific architectural designs.**
- They built imposing buildings as a show of power.
- They also introduced the concept of anonymous architecture which involves simple facade without much ornamentation or design, much like modern buildings.
- **French also developed coastal towns** of Mahe (Kerala), Karaikal (Tamil Nadu) and Yanam (Andhra Pradesh).
- Imprint of French style of architecture can be clearly distinguished in different infrastructures of the region including 'Pondicherry International Port', police stations and banks.
- Some of the finest example of french influence are
 - **Church of Sacred Heart of Jesus in Puducherry**
 - **Church of Chandannagar**



A grid plan from 1799 of Pori, Finland, by Isaac Tillberg



**Sacred Heart of Jesus Basilica,
Pondicherry**



Church of Chandannagar

Danish Architecture

- The Danish fleet led by Ove Gjedde landed in Tranquebar (Tharangambadi) in 1620, after an almost 2 year expedition during which they sailed through England, Africa.
- Initially they settled at Masulipatnam.
- As Tranquebar was the Danish outpost in India for over 200 years..
- Their town planning was laid out in squares and canals.
- Some of the. danish architecture style buildings are
 - **Towngate and landporten**
 - **The Danish Fort**
 - **New Jerusalem Church**



Towngate, Tamil Nadu



Danish Fort, Tamil Nadu

- It was built in 1620.
- The fort was used to house soldiers, and as a warehouse for food, and artillery.



The New Jerusalem Church, Tranquebar

- It was built under the leadership of Ziegenbalg in 1718.
- Ziegenbalg is buried in this church, though his crypt is off limits to visitors.

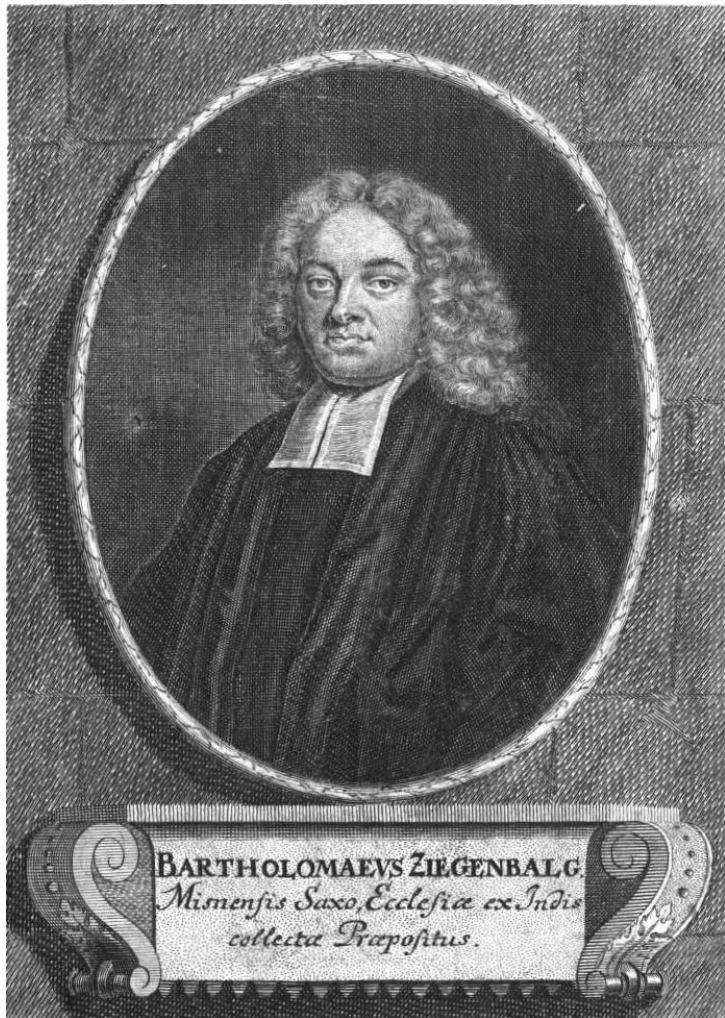

Bartholomäus Ziegenbalg was the first Protestant missionary to land in India, sent as a royal missionary by King Frederick IV, from the Kingdom of Denmark.

- landed at Tranquebar 1707.
- attended the local school, sat amongst the village children, and learnt Tamil. He set up a Tamil seminary in 1707, and preached Christianity to the villagers.
- In 1711, he convinced the Martin Luther University at Halle to start scholarly study into the Tamil language.
- 1715, translated the Bible into Tamil and helped set up India's first **printing press** at Tranquebar, with Tamil being the first Indian language to be printed.
- championed the cause of **women's education** and for abolition of caste system, and gained the respect of the local people.
- established the very first school for girls in India at Tranquebar in 1707
- Between 1717 and 1718, he helped establish the **New Jerusalem Church** at Tranquebar for the use of the native people, conducting services in Tamil.
- Ziegenbalg died on 23 February 1719, aged 37, and is buried in the New Jerusalem Church

British Architecture

- The British brought with them the **Gothic style of architecture**. It merged with the Indian architecture and resulted in the Indo-Gothic style of architecture.
- Initially British architecture adopted Gothic style.
- In later phase they adopted **Indo-Gothic style also known as Indo-Saracenic style of architecture**.
- **Post-1911**, a new style of architecture known as the **Neo-Roman architecture** emerged.
- The initial theme of buildings were **factories, courts, schools, municipal hall and Dak bungalows**.
- Later the **Church, forts** and other monuments were built from the mid of the 18th century onwards.
- Some of the examples are **St Mary's Church of Kolkata** and **Indian Government Mint Kolkata**.
- Buildings were mostly made up of brick and stuccoed with lime plaster, sometimes "facades" incised to look like stones.

- Gothic Style -> Neo-Gothic (1740+)
- Indo-saracenic (1870+ - early 20th cent.)
 - Indo-gothic
 - Indo-gothic-victorian
- Neo-Roman (1911+)



St. Mary Church in Fort St. George in Chennai is highly influenced by Churches of London. It was built in 1787



Indian government mint in Kolkata which is influenced by Temple of Minerva at Athens.



An 18th-century sketch of the Fort St. George

Neo-Gothic Architecture (1850+)

- Gothic Revival that goes by different names such as Victorian Gothic, Neo-Gothic
- Gothic is an architectural style that had begun to take shape in the late 1740s in England.
- It consists of
 - tall designs
 - decorative patterns
 - finials
 - lancet windows (a slender pointed arched window)
 - hood moulds
- It became a standard design style by mid 19th century.
- Examples-
 - **City of Bombay**
 - **Town hall of Bombay**
 - **Calcutta High court building**
 - **Fort William, Calcutta**

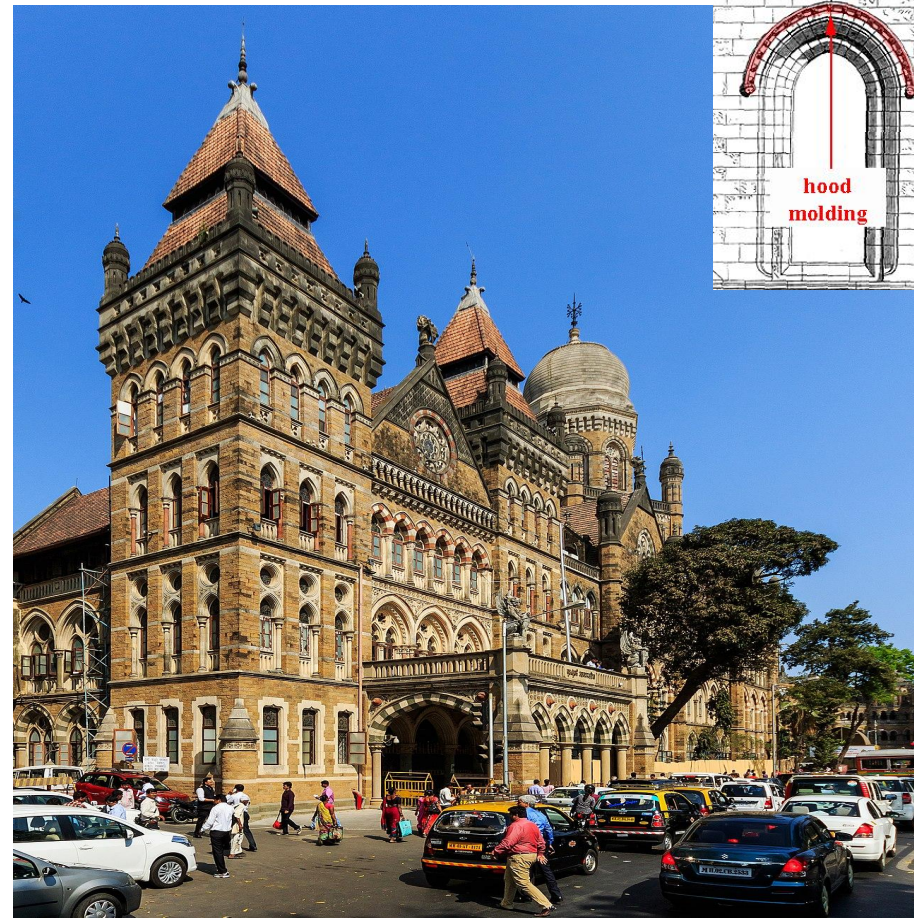

Municipal corporation Building of Mumbai

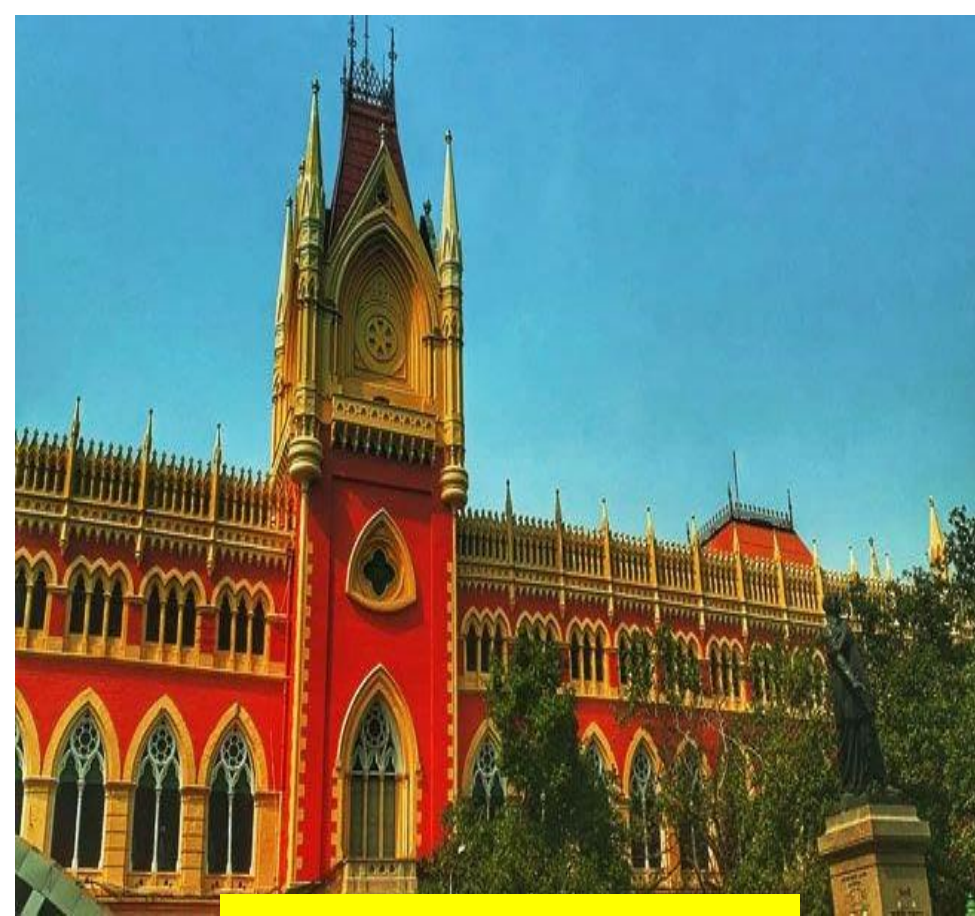

Calcutta High Court



Town Hall Mumbai

It is influenced by the House of Parliament in London

Engraved for the Universal Magazine, for J. Flinton in Newgate Street.



A Perspective View of FORT WILLIAM, in the Kingdom of BENGAL; belonging to the East India Company
of ENGLAND.

Fort William, a view from the inside in 1828

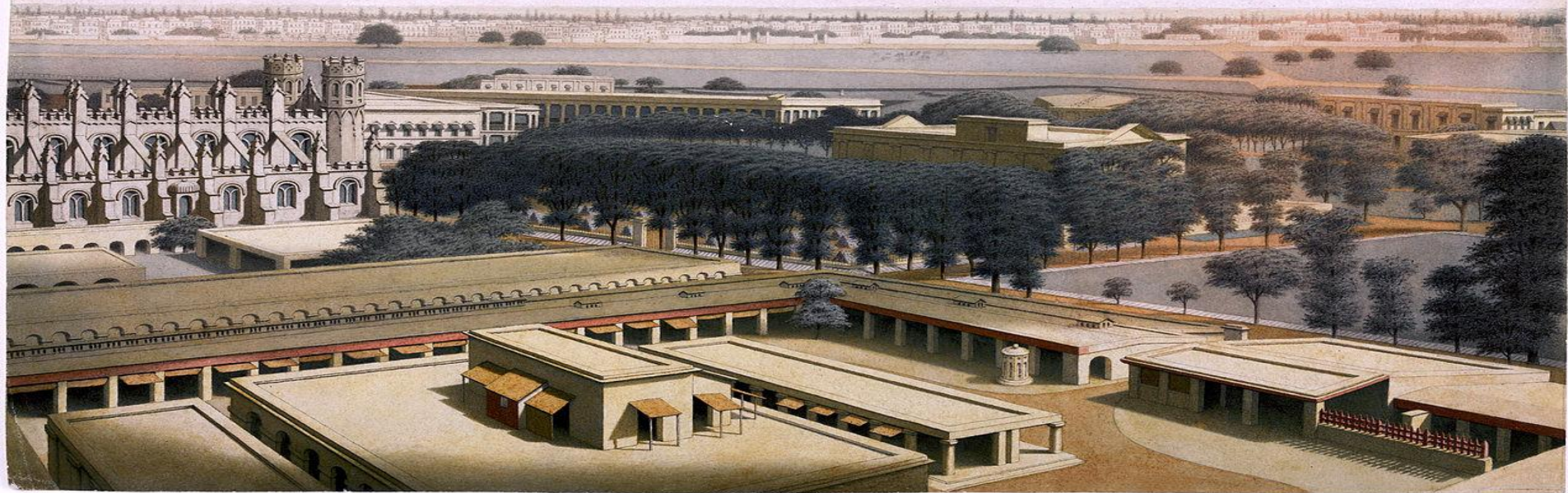

Difference between Iberian and Gothic Architecture

Basis	Iberian Architecture	Gothic Architecture
Material Used	Brick was the main material used by the portuguese. Wood was used for roofs and stairs.	Red sandstone and coarse Limestone were primarily used.
Structural Variations	The Portuguese continued with their western traditions and did not introduce any structural variations.	The British adopted Indian motifs and styles, giving rise to the Indo-Gothic style of architecture.

Indo-Saracenic style

- The Indo-Saracenic style has origin in Syria during pre-Islamic period hence the name.
 - A branch of the **Syrian architecture moved into Europe** and assumed the form of **Gothic style**.
 - **Another branch moved into central Asia and came to India along with the Turkish conquerors.** This second branch was continued in India by the Turks and the Mughals.
- This style emerged in around the middle of the 18th century and continued to flourish throughout the period of British rule in India.
- It is also known as **Mughal Gothic and Indo-Gothic style of architecture.**
- However, it basically refers to the style that diffused from the 1870's to the early 20th century for colonial buildings in India, adding the elements of Mughal architecture, to the base of Victorian Gothic style.
- In nutshell the next architectural style after Mughals and arrival of European was broadly Indo-Saracenic style however it further subdivided into various style depending on the influence of ideas.

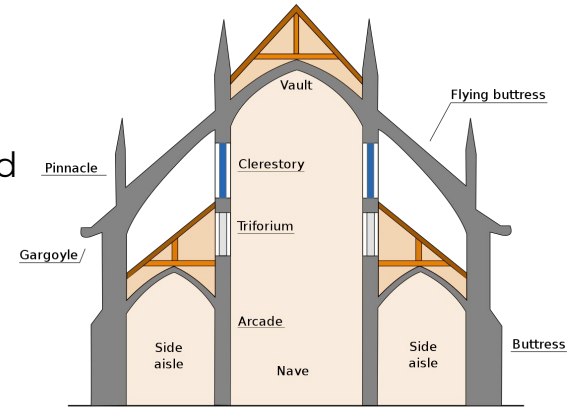

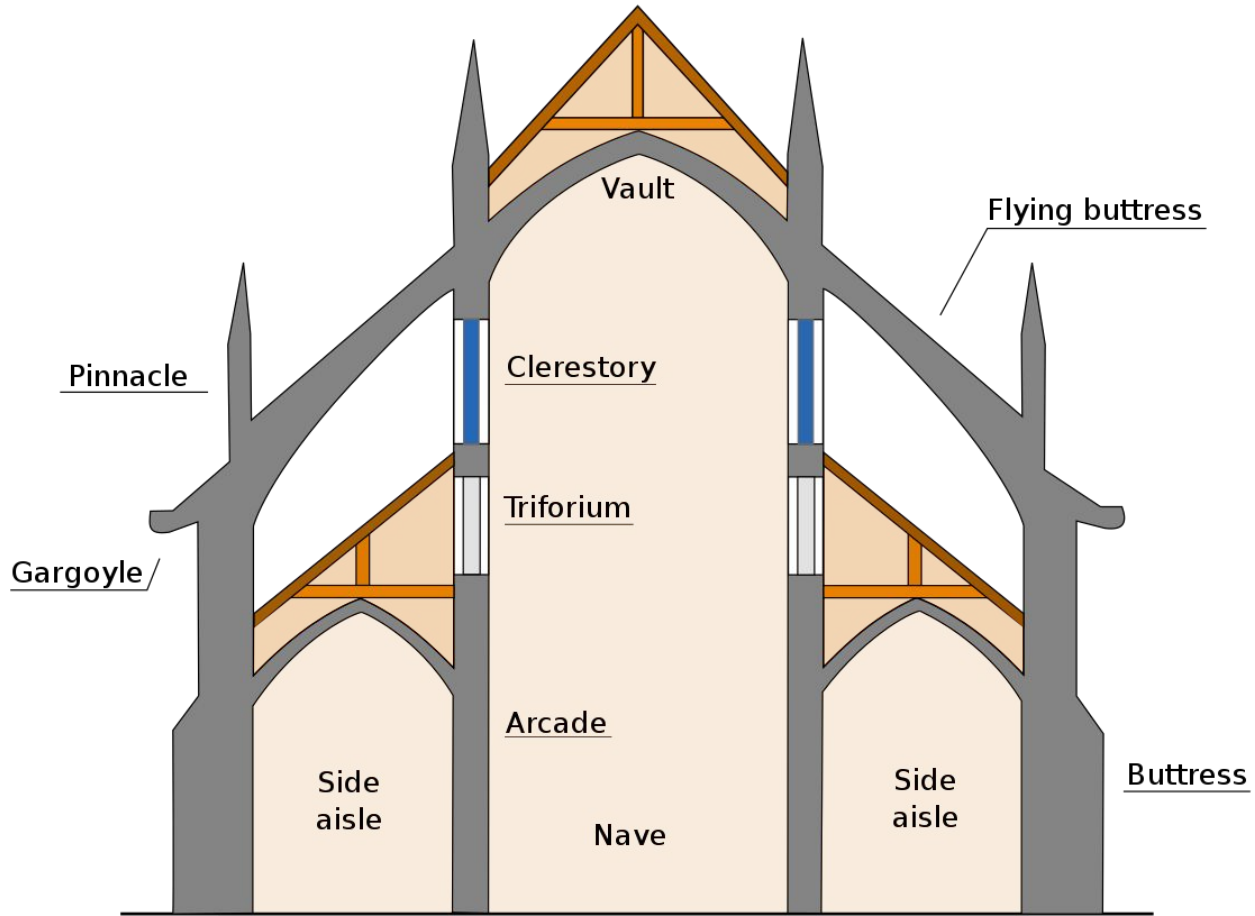

PROMINENT INDO-SARACENIC MONUMENTS

St. Paul's Cathedral

- Location: **Kolkata**
- Designed by **Major William Nairn Forbes**, assisted by **C.K. Robinson**
- Built by **Bishop Daniel Wilson**
- Construction commenced in 1839 and completed in 1847

Victoria Memorial Hall

- Location: **Kolkata**
- Presently a **museum**, it is an autonomous institution under **Ministry of Culture** (Government of India)
- Designed by **Sir William Emerson**
- Its gardens were designed by **Lord Redesdale and Sir David Frain**

Esplanade Mansion

- Location: **Mumbai**
- Originally known as **Watson's Hotel**
- Named after its original owner, **John Watson**
- India's **oldest surviving cast iron building**
- Fabricated in England and constructed on site between 1860 and 1863
- Designed by the civil engineer **Rowland Mason Ordish**
- Resembles **London's Crystal Palace**

General Post Office

- Location: **Kolkata**
- Designed by **Walter B. Grenville** in 1864

Madras University Senate House

- Location: **Chennai**
- Designed by **Robert Chisholm**
- Built between 1874 and 1879

Madras High Court

- Location: **Chennai**
- Designed by **J.W. Brassington**
- Built in 1892
- Completed by **Henry Irwin** with the assistance of **J.H. Stephens**

- **The chief characteristics of the style:**

Synthesis of, Mughal designs, Indian material and modern European civil engineering techniques.

- In terms of forms and features, arches, domes and minarets were used just like in the Mughal period.
- Modern European civil engineering techniques, such as **iron and steel structures** and **poured (pre-mixed) concrete**, were used in construction.
- **Spires, stained glass, vaulted roofs, pinnacles, cusped arches, tracery, open arcade** and open pavilions were used in a playful manner in the monuments of this style.
- Unlike the Mughal buildings, the British architecture was need oriented. This style of architecture manifested itself in the form of **public buildings such as post office, railway stations, banks, insurance buildings, educational institutions, clubs, museums, etc.**
- **Examples of this style:**
Chepauk Palace,
Gateway of India,
Victoria Memorial Hall,
Writer's Building (Kolkata),
Chhatrapati Shivaji Maharaj Terminus etc. are some of the prominent monuments of Indo-Saracenic style.





Chepauk Palace

- designed by Paul Benfield (Chennai) was the first monument of Indo-Saracenic architecture.
- It was built in 1768 AD by Nawab of Arcot as his official residence.



Gateway of India, Mumbai

- Designed by **George Wittet**
- Built in the memory of the visit of **King George V and Queen Mary** in 1911
- Height is 26 metres (85 feet)
- Often referred to as the **Taj Mahal of Mumbai**



Lakshmi Vilas Palace, Gujarat

The palace was constructed in 1890 by the will of Maharaja Sayajirao Gaekwad III and was designed by a prominent architect named Major Charles Mant



Writer's Building, Kolkata

- Designed by Thomas Lyon in 1777
- St Anne's Church was located at its site earlier
- The first 3-storeyed building in Kolkata



Chhatrapati Shivaji Maharaj

Terminus, Mumbai

- Designed by Frederick William Stevens
- Built in 1887 to commemorate Golden Jubilee of Queen Victoria
- A historic railway station
- A UNESCO World Heritage Site

Indo-Gothic Style

Under Indo-Saracenic style gothic revival took place which goes by different names. It is also known as **the Victorian style**, was a unique blend of Indian, Persian and Gothic styles of architecture. Some of the features of Indo-Gothic style are:

- The constructions were extremely large and elaborate in their execution.
- The walls were thinner than in the Indo-Islamic constructions.
- Thinner walls is the part of modern structural design.
- The **arches were pointed**, unlike the curving arches of Indo-Islamic era.
- One of the unique features of the Victorian style was **the use of large window and pointed arches.**
- The churches had a **crucified ground plan.**
- It was an hybrid style which have both the elements of Hindu and Mughals with gothic cusped arch, domes, spires, tracery, minarets and stained glasses.
- Some of the prominent architects were **FS Growse, Sir Swinton Jacob, RF Chisholm and H.Irwin.**
- **It adhered to advanced structural engineering standards of Britain. Steel, iron and poured concrete started being used.**

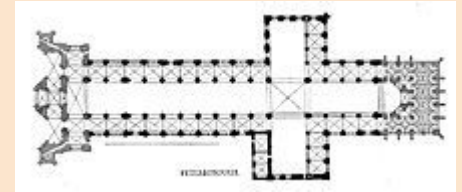

Indo- Gothic Victorian substyle

(Victorian-Gothic style)

The Victorian Gothic Architecture thus, was basically a hotchpotch of early European styles mixed with the introduction of Middle East and Asian influences.

- **Features**

- Bulbous domes along with many miniature domes
- Overhanging eaves
- Pointed arches, cusped arches, or scalloped arches
- Vaulted roofs
- Domed chhatris, pinnacles, towers and minarets
- Open pavilions
- Pierced arcades.

Some of the monuments of Victorian-Gothic style are

- *Victoria Memorial in Kolkata*
- *Gateway of India in Mumbai*
- *Prince of Wales Museum*
- *Maharaja's Palace at Mysore*
- *Lakshmi Vilas*
- *St, Paul Cathedral, Kolkata*
- *Victoria Terminus*



Victoria Memorial, Kolkata

- It is a large marble building in Central Kolkata, West Bengal, India which was built between 1906 and 1921.
- Its architect was William Emerson.
- The design is in the Indo-Saracenic revivalist style which uses a mixture of British and Mughal elements with Venetian, Egyptian, Deccani architectural influences.



Empress Victoria's statue inside the memorial

Gateway of India, Mumbai



- It is an arch-monument built in the early 20th century.
- It was erected to commemorate the landing of King-Emperor George V, the first British monarch to visit India, in December 1911.
- This monument built in the Indo-Saracenic style, incorporating elements of 16th-century Gujarati architecture.
- The final design of the monument by architect George Wittet was sanctioned only in 1914, and construction was completed in 1924.



Prince of Wales Museum, Mumbai

- It was founded in the early years of the 20th century.
- The museum was renamed in 1998 after Chhatrapati Shivaji Maharaj.
- The building is built in the Indo-Saracenic style of architecture, incorporating elements of other styles of architecture like the Mughal, Maratha and Jain.
- It is a three-storied rectangular structure, capped by a dome set upon a base, which adds an additional storey in the centre of the building.
- The building incorporates features like Islamic dome with a finial along with protruding balconies and inlaid floors, inspired by Mughal palace architecture.



Mysore Palace, Karnataka

- The palace is in the centre of Mysore, and faces the Chamundi Hills eastward..
- The architectural style of domes of the palace is commonly described as Indo-Saracenic, with blends of the Hindu, Mughal, Rajput, and Gothic styles.
- The three-storey stone building of a fine grey granite with deep pink marble domes has a facade with several expansive arches and two smaller ones flanking the central arch, which is supported by tall pillars.

Lakshmi Vilas Palace, Vadodara



- It was constructed by the Gaekwads who ruled the Baroda State.
- Major Charles Mant was credited to be the main architect of the palace.
- Lakshmi Vilas Palace was styled on the Indo-Saracenic Revival architecture, built by Maharaja Sayajirao Gaekwad III in 1890.



St. Paul's Cathedral, Kolkata

- It is noted for its Gothic architecture
- The cornerstone was laid in 1839
- the building was completed in 1847.
- The Imperial Gazetteer defined the architectural design of the cathedral as "Indo-Gothic", to mean a Gothic architectural style built to meet the climatic conditions of India.
- The cathedral's design, otherwise known as Gothic Revival style, includes three stained-glass windows and two frescoes in the Florentine Renaissance style



Victoria Terminus, Mumbai

- It is also known as Chhatrapati Shivaji Terminus.
- It is also a historic terminal train station and UNESCO World Heritage Site in Mumbai
- The terminus was designed by a British architectural engineer Frederick William Stevens from an initial design by Axel Haig, in an exuberant Italian Gothic style.

Neo-Roman Style

Post-1911, the constructions undertaken by the British Raj were done according to **Neo-Roman style or Neo-Classical style**. The architectures of New Delhi, done by **Edwin Lutyens** and **Herbert Baker** were the finest examples of this style. It has been often described as the **"Rome of Hindustan"**.

The features of this phase are:

- The constructions were anonymous and without any interesting features.
- It was a confluence of all styles of architecture which made the style congested and cramped the space of artistic expression.
- Simplicity, modernity and utility were highly compromised due to the hybrid nature of the constructions.

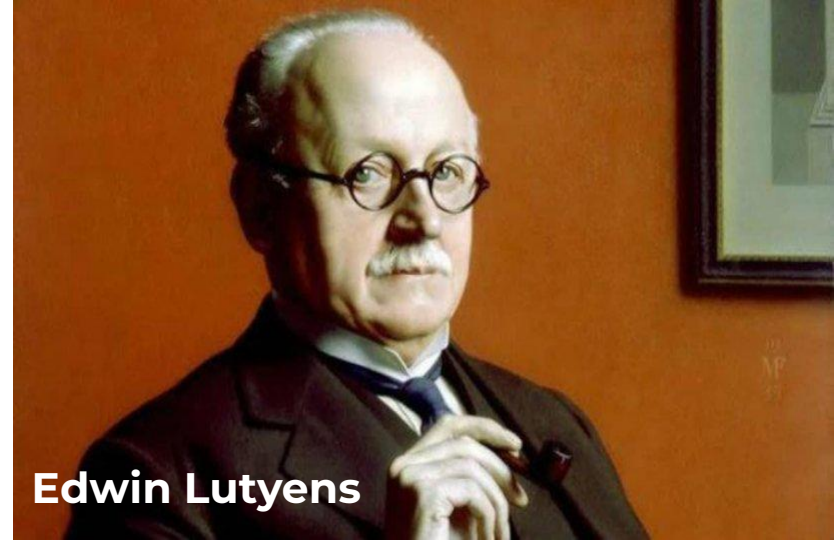

Edwin Lutyens



Herbert Baker

- There was a **focus on circular buildings**.
- There was an overuse of oriental motifs to realise western architectural designs.
- The concept of upturned dome, circular buildings and hybrid structure were included in this style. For example **St Martin's Garrison Church** is the best example of early Neo-Roman style.

- **The making of New Delhi**

To design Delhi there is contribution of three main architects which designed various parts of Delhi

- **Herbert Baker** designed South Block & North blocks
- **Robert Tor Russell** designed Connaught Palace



St. Martin's Garrison Church, Delhi



South Block Delhi

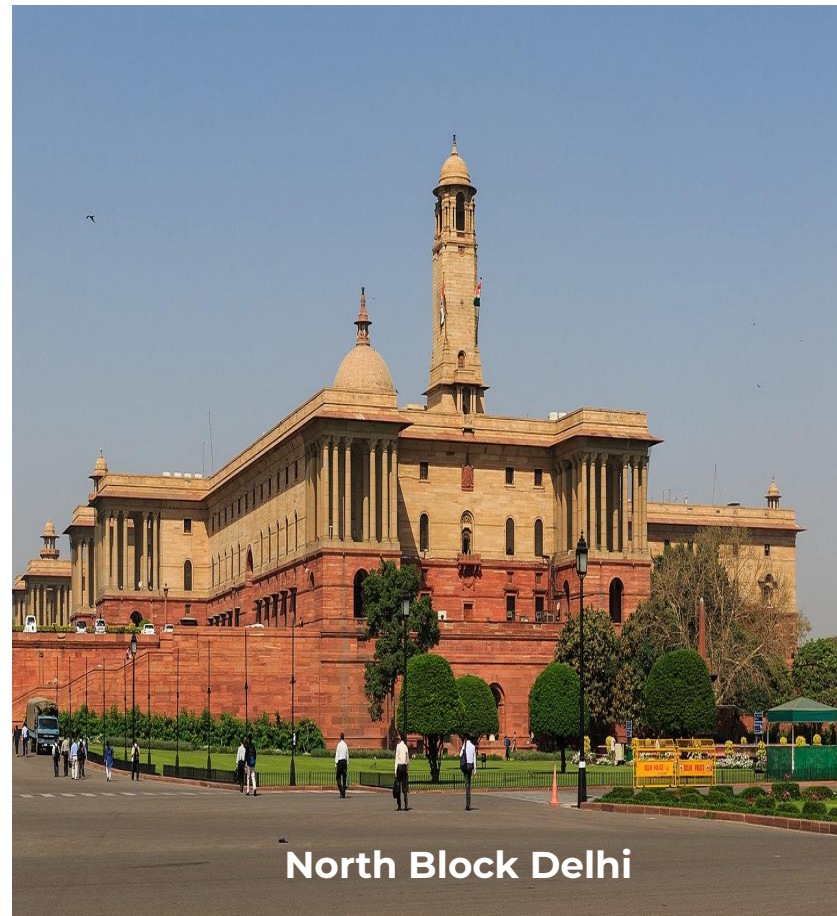

North Block Delhi

Herbert Baker designed the South and North Block, earlier the offices of british residents were located in these blocks.



Connaught Palace

- Construction work started in 1929 and completed in 1933
- Named after the Duke of Connaught

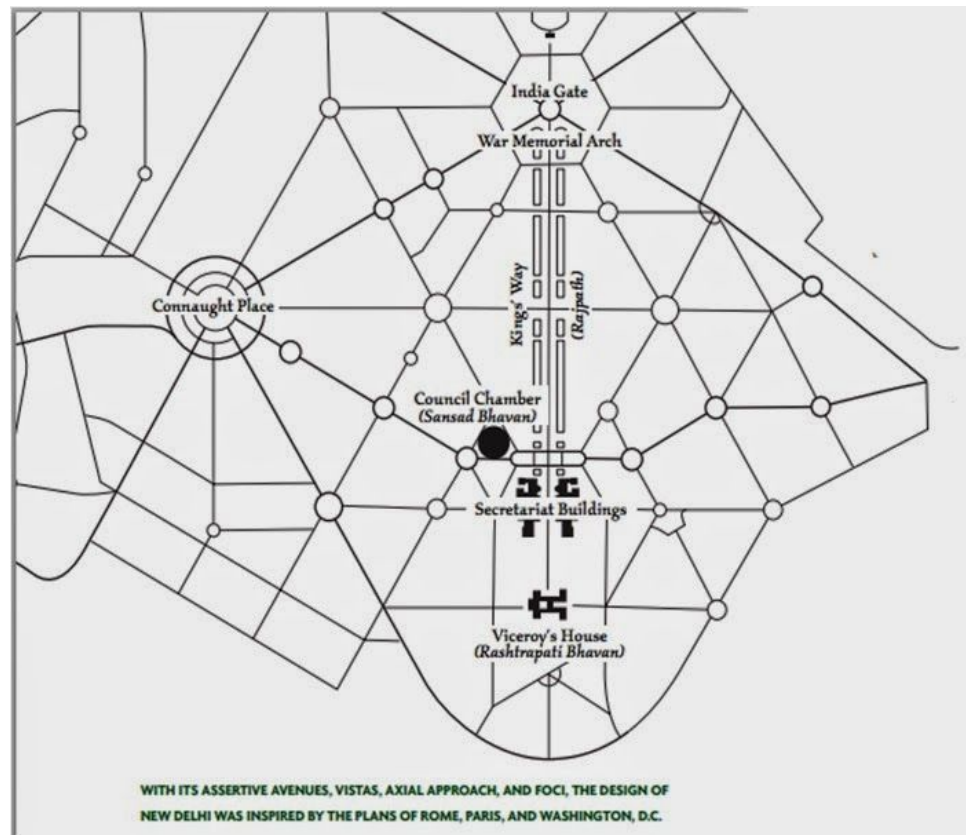

Building of Lutyens Delhi

Edwin Lutyens who was the main architect behind the designing of Delhi including Rashtrapati Bhawan, Parliament House.

Overview

- He designed the structure such that the Raj path from the President's house to the India Gate and the Canopy beyond for the statue of King George.
- **East-west Axis**
 - The Rajpath (also known as Kingsway) starts from Raisina hills to the Yamuna and the Indraprastha (oldest city).
 - This axis is cut at the right angles by the other axis of the city known as Janpath (Queensway).
 - The straight and tree lined boulevard, Delhi has often been compared to Paris.

It took 20 years to complete these buildings along with 112 bungalows.

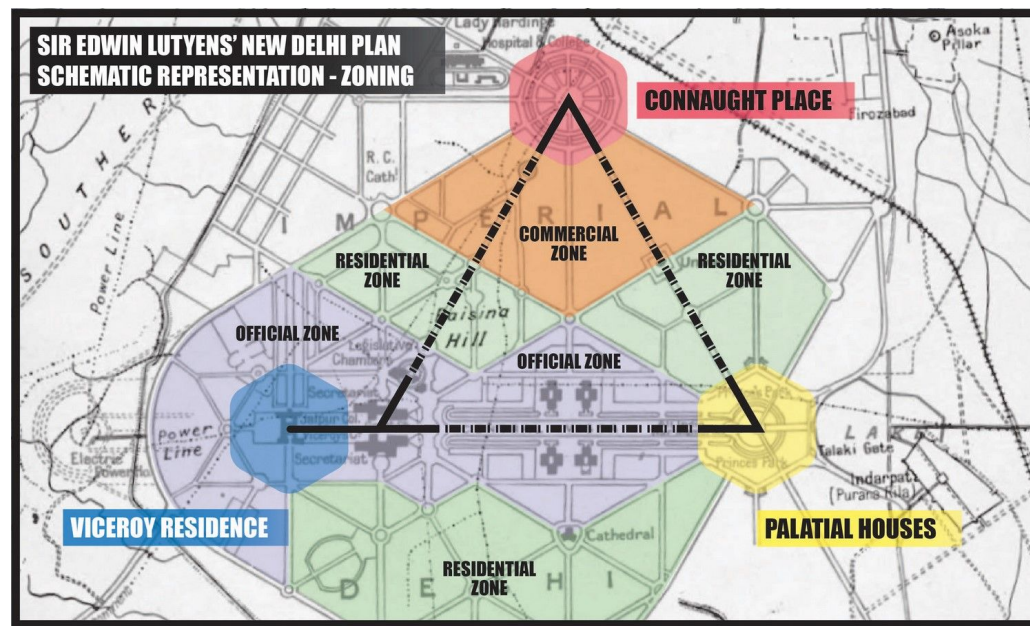

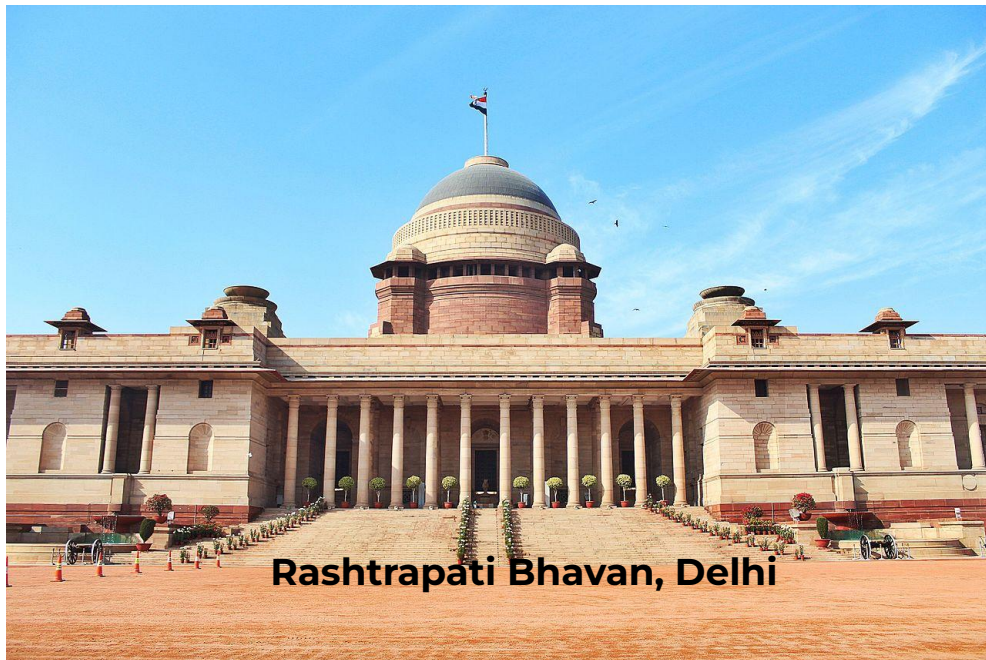

Rashtrapati Bhavan, Delhi



Main facade of building



Parliament House

- Designed by Herbert Baker and Edwin Lutyens in 1912-1913
- Construction began in 1921 Opened in 1927



The circular House of Parliament in New Delhi, home of the Central Legislative Assembly



India Gate

- Location: New Delhi
- Designed by **Edwin Landseer Lutyens**
- Built in 1931
- Inspired by the **Arc de Triomphe located in Paris**, which was inspired by the Roman Arch of Titus
- Originally known as the **All India War Memorial**
- Commemorates 90,000 soldiers of the British Indian army who lost their lives in **World War I and Third Anglo-Afghan War**
- Composed of **red and pale sandstone and granite**
- After Indian independence, the India Gate became the **site of the Indian Army's Tomb of the Unknown Soldier**, known as **Amar Jawan Jyoti (the flame of the immortal soldier)**

Post-independence Architecture

After 1947, two schools of architecture emerged – the Revivalist/historicism and the Modernist

Revivalist advocated the continuity with past

Modernists depends heavily on the European and American models adopted them in India without taking consideration the regional aspirations, diversities and requirements.

The architects were successful in creating an architecture which could define the post-independence era to some extent. Right from commercial architecture, urban design and re-development, low cost architecture to housing, institutional, industrial and sensitive issues like conservation and sustainable architecture; all have acquired an exceptional connotation.

Jawaharlal Nehru, the first Prime minister of India had a far vision for the betterment and development of art and architecture in India. He invited **Le Corbusier (Swiss, French)** to design the capital of the state Punjab, Chandigarh. Le Corbusier designed the Legislative Assembly, Secretariat and High Court.

Contemporary Indian architecture to a large extent is reflected in its new boom of corporate campuses, shopping malls, and skyscrapers. Many of them reflect a growing trend of sustainable and green architecture. These contemporary architects have induced a multi disciplinary approach to architecture which includes consideration of climate, ecology, energy efficiency, engineering and programming skills, use of 3d for better visualization, alternative technology and lost cost architecture.

Le Corbusier

1887 - 1965

- He is the best-known architect recruited to the efforts of creating a new India was one of the founders of modernism in architecture, the Swiss Le Corbusier.
- The showpiece of his genius is Chandigarh, built as the capital of Punjab and Haryana.
- He divided city in three sections
 - **Head-** consisted of political, bureaucratic and judicial building, the administrative part of the city.
 - **Body-** houses the university and residential complexes in the heart of the city.
 - **Feet-** considered of industrial sectors and the railway station.
- Outside Chandigarh Le Corbusier's most influential structures include:
 - Sarabhai House, Ahamadabad
 - Millowner's Association Building, Ahmedabad.
 - Permanent Exhibition Hall of Prāgati Maidan, New Delhi
- He was one of the founding fathers of the modernist movement and of what has come to be known as the "International Style" in architecture.
- He is best known for the **idea of a house as a "machine" to live in.**
- His urban planning ideas were influential; readily accepted and implemented on grand scale.

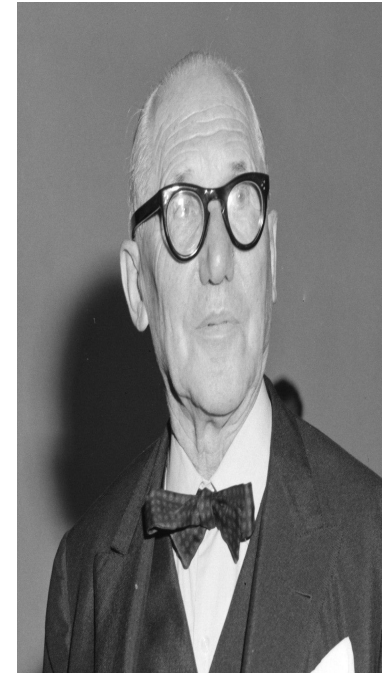

The Five Points of a Modern Architecture

Le Corbusier defined the principles of his new architecture in *Les cinq points de l'architecture moderne*, published in 1927, and co-authored by his cousin, Pierre Jeanneret.

They summarized the lessons he had learned in the previous years, which he put literally into concrete form in his villas constructed of the late 1920s, most dramatically in the Villa Savoye (1928–1931)

The five points are:

1. **The Pilotis, or pylon.** The building is raised up on reinforced concrete pylons, which allows for free circulation on the ground level, and eliminates dark and damp parts of the house.
2. **The Roof Terrace.** The sloping roof is replaced by a flat roof; the roof can be used as a garden, for promenades, sports or a swimming pool.
3. **The Free Plan.** Load-bearing walls are replaced by steel or reinforced concrete columns, so the interior can be freely designed, and interior walls can be put anywhere, or left out entirely. The structure of the building is not visible from the outside.
4. **The Ribbon Window.** Since the walls do not support the house, the windows can run the entire length of the house, so all rooms can get equal light.
5. **The Free Façade.** Since the building is supported by columns in the interior, the façade can be much lighter and more open, or made entirely of glass. There is no need for lintels or other structure around the windows.



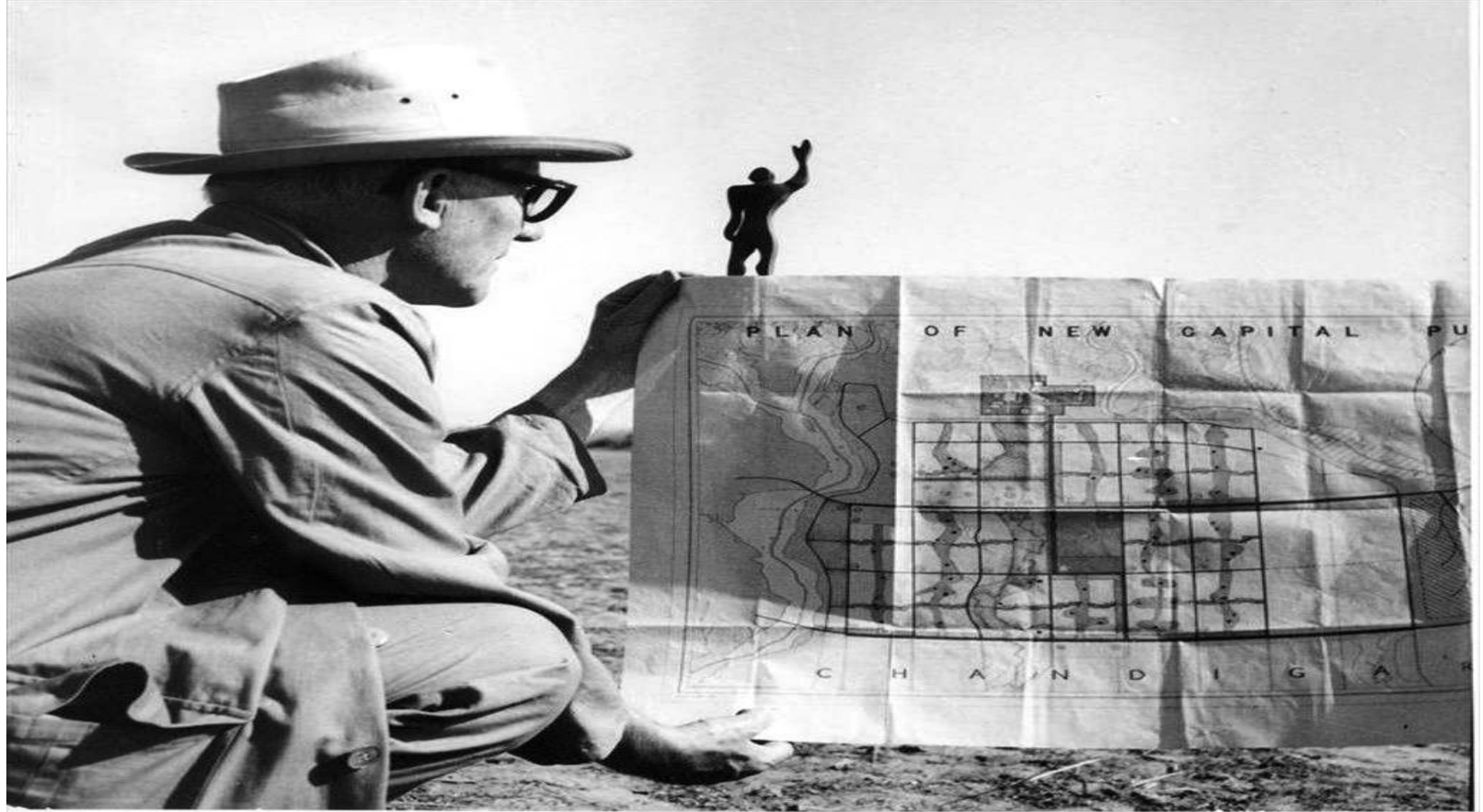

Le Corbusier holding the master plan of Chandigarh



Capitol Complex of Chandigarh

**Legislative Assembly Building,
Chandigarh**

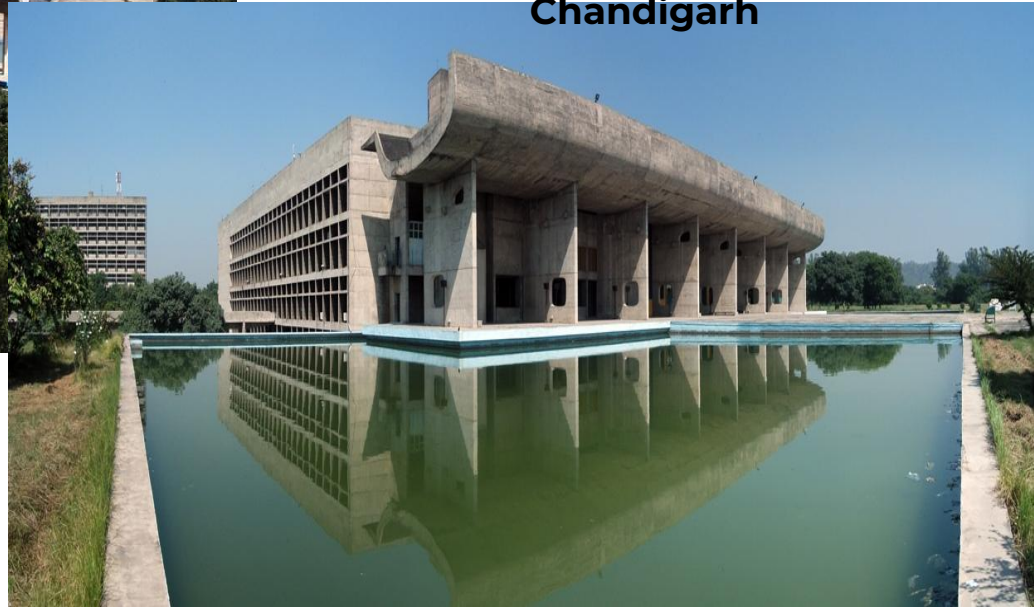



**Open Hand Monument,
Chandigarh.**



High Court Building, Chandigarh



High Court Building, Chandigarh



Mill Owners' Association Building, Ahmedabad

Ahmedabad, a new cultural and architectural waking was initiated by textile industrialists led by the Sarabhai family who commissioned Le Corbusier to work on five projects there. Le Corbusier designed the Mill Owner's Association Building Headquarters for the Textile Company 1954.

1950s also saw a significant expansion of architectural education. In 1947, there were three schools: at **Baroda, Bombay and Delhi.**

Some of the architects came back to India after education and training in western countries which resulted in strong architectural character.

- **Charles Correa**
- **B.V. Doshi**
- **Raj Rewal**
- **Achyut Kanvinde**

Five distinct approaches of architectural expressions developed:

1. **Plastic or geometric forms** exploiting the potential of concrete used to express distinct and bold forms, volumes and shapes growing out of functional needs.
2. New language of **exposed brick and concrete**
3. **Bold and aggressive articulation of structural elements**- an expression of Brutalism like Kenzo Tange, James Sterling, Moshe Safdie
4. Sensitive approach to **harmonizing with the micro environment** that is reminiscent of the best traditions of F.L.Wright and Richard Neutra
5. **Regionalism** – an amalgamation of modernism with traditional experience of town planning, neighbourhood clustering, harmonize with nature, climate control and using local materials



Supreme court

- The foundation stone of the Supreme Court's building was laid on **29 October 1954** by Dr. Rajendra Prasad, the first President of India.
- The main block of the building has been built on a triangular plot of 17 acres and has been designed in an Indo-British style by the chief architect **Ganesh Bhikaji Deolalikar**, the first Indian to head the Central Public Works Department.
- The building is shaped to symbolize scales of justice with its centre-beam being the Central Wing of the building,
- The Right Wing of the structure has the Bar, consisting of rooms, the offices of the Attorney General of India and other law officers and the library of the court.

Hall of Nation

- It was a building designed by the Indian architect **Raj Rewal**, and structurally engineered by **Mahendra Raj**, that was inaugurated in **1972** as part of the Pragati Maidan exhibition complex in New Delhi.
- It is characterized by
 - monumental, truncated pyramid form with a space frame structure made of concrete elements. The depth of the structural
 - system used as a sun-breaker and conceived as a traditional jail.
- The structure was demolished in April 2017 to make way for a new complex.
- The demolition of building led to widespread global disapproval.
- It was described as Brutalist masterpiece" as it was one of the world's largest-span space frame concrete structures, when built.





New Delhi Municipal Council (Palika Kendra)

- It is a 21-story building on Sansad Marg, New Delhi, India. Designed by **Kuldip Singh and Mahendra Raj**.
- **It was inaugurated in 1984**
- It features Brutalist architecture.
 - **Brutalist architecture** is an architectural style which emerged during the 1950s in the United Kingdom, among the reconstruction projects of the post-war era.
 - It is characterised by minimalist constructions that showcase the bare building materials and structural elements over decorative design.
 - Descending from the modernist movement, Brutalism is said to be a reaction against the nostalgia of architecture in the 1940s.

Lotus Temple, Delhi

Completed - 1986

- It is located in Delhi, India, is a Bahai House of Worship.
- The building was completed in 1986.
- It is notable for its flowerlike shape.
- It is composed of 27 free-standing marble-clad "petals" arranged in clusters of three to form nine sides.
- It is designed on **expressionist style** of architecture.
- The architect and structural engineer of Lotus Temple are **Fariborz Sahba** and firm of Flint & Neill.

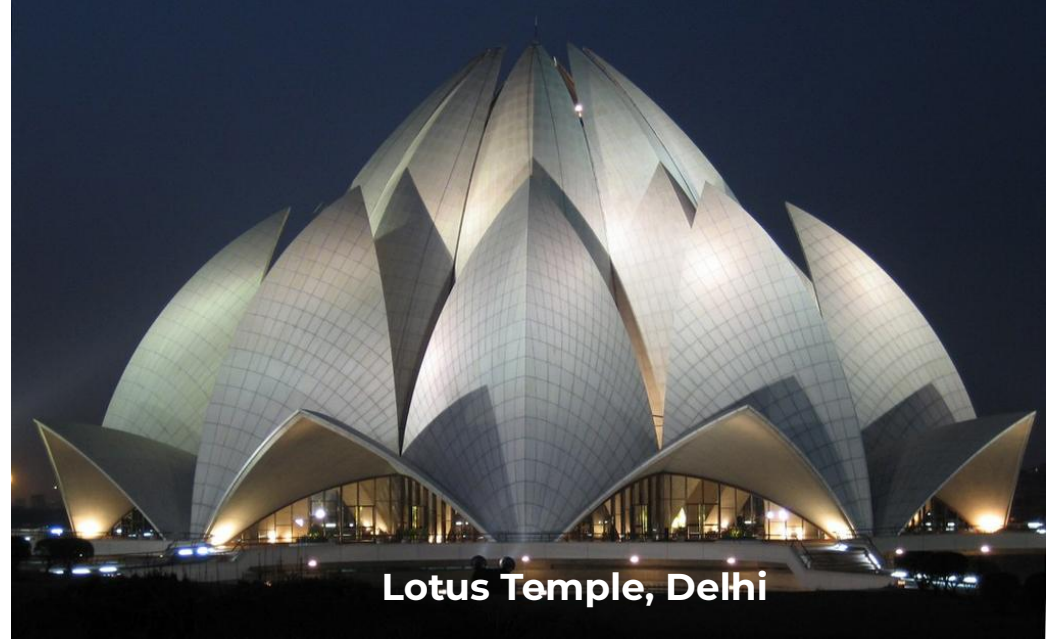

Lotus Temple, Delhi

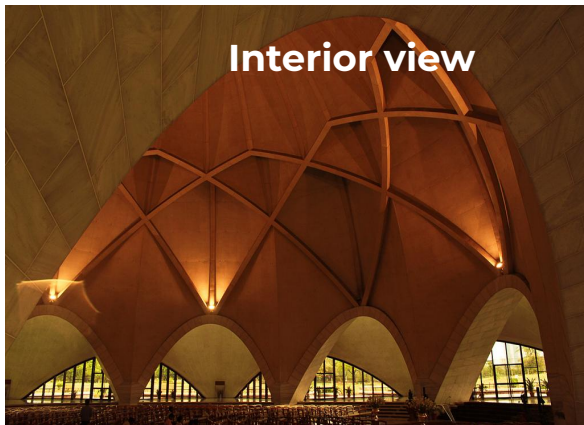

Interior view

Laurie Baker

Gandhi of Indian architecture

1917 - 2007



- He is Known as “**conscience keeper of Indian architecture**” and "**Architect of the Poor**".
- responsible for the revolutionised mass housing concept in Kerala.
In 2006, he was nominated for **Pritzker Prize** dubbed as Nobel Prize for architecture.
- He is considered a builder of affordable homes for the poor.
- His greatest contribution was showing that cost-effective and ecologically sustainable construction does not automatically imply shoddy building and reduced creative freedom.
- His method was the very opposite of the prevalent model in India which followed the British system. At a time when Indian architects were following the British way of designing and directing operations from their drawing boards as ‘consultants’ far away from the bustle of the site, Baker organized his work as a designer-builder in the manner of the traditional Indian mason.

Pritzker Prize

- The Pritzker Architecture Prize is awarded annually "to honor a living architect or architects whose built work demonstrates a combination of those qualities of talent, vision and commitment, which has produced consistent and significant contributions to humanity and the built environment through the art of architecture.
- It is considered to be one of the world's premier architecture prizes, and is often referred to as the Nobel Prize of architecture.

- He generally sketched on wastepaper, and designed largely on site. His personal approach resulted in the cost-effectiveness design, which would have been impossible in normal professional mode.
- His architecture has been associated with **brick (largely exposed), landscaped courts, jaalis, traditional Indian sloping roofs.**
- He did profess that an architect's design responsibility is realised when the user is not just kept in mind but understood by his manner of living, within the space as well as in the regional spirit of collective growth, in the physical as well as time frames.
- He introduced the concept of filler slab construction to reduce the consumption of steel and cement.
- He also laid emphasis on **ventilation and thermal comfort** arrangements and construction of environment-friendly buildings by using locally available material.

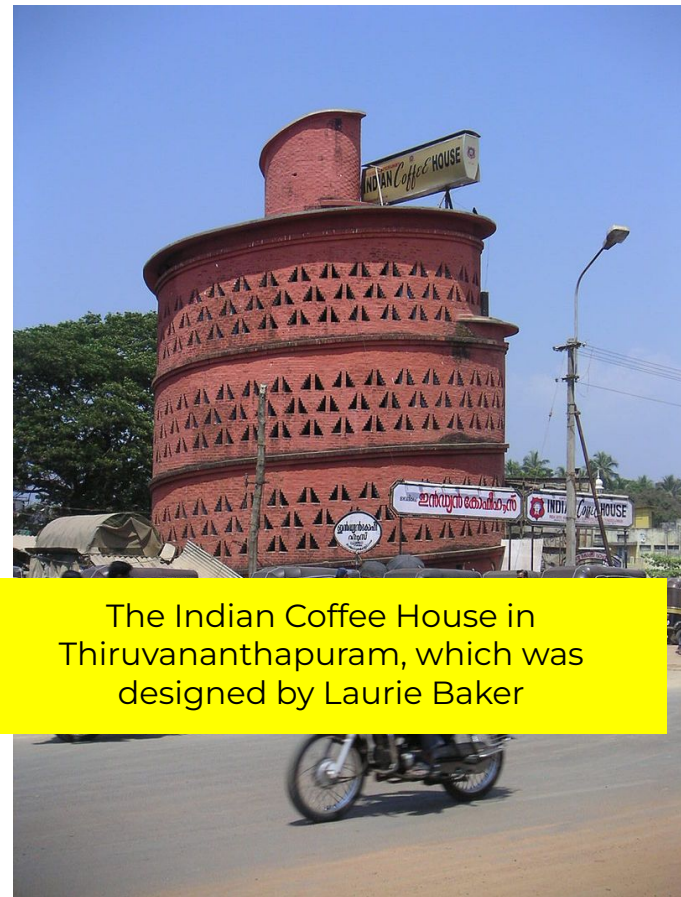

The Indian Coffee House in Thiruvananthapuram, which was designed by Laurie Baker

Louis Baker have designed affordable low cost housing in Kerala.

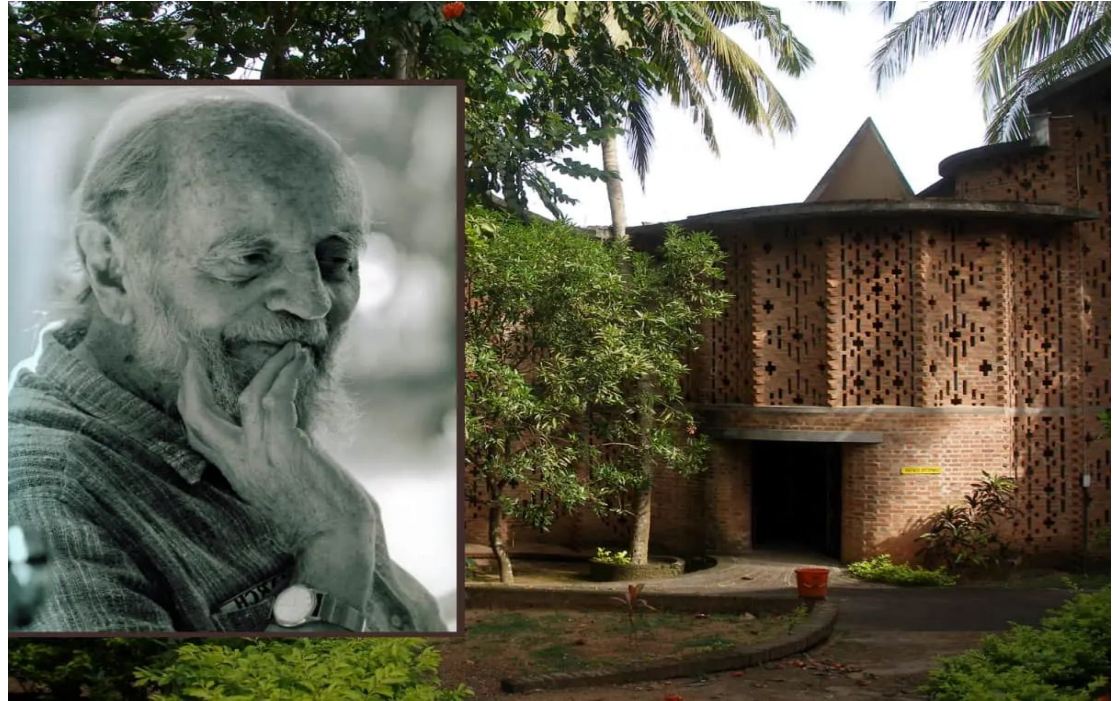

Laurie Baker and his mass housing project

Charles Correa

1930-2015

- He is known for his work in **urban architecture** and **spatial planning**.
- He adopted modern architectural principles to local sensibilities and need.
- He played pivotal role in the creation of architecture for post-Independence India.
- His works have brought forth a skilful **use of colour** in Indian architecture.
- His style implies adeptness in comprehending traditional architecture and in merging the modern typology with South Asian elements.
- The visual imagery and treatment of surfaces brings an element of youthfulness in all his projects. His famous projects are **Cidade de Goa** shows his artistic play of light and shade on the walls. **Mahatma Gandhi Memorial Museum** at the Sabarmati Ashram in Ahmedabad and the **Jawahar Kala Kendra 1986 in Jaipur**.
- He is also behind the planning of Navi Mumbai, MIT'S Brain and Cognitive Sciences Centre in Boston and the Cidade de Goa in Goa.
- He has designed buildings like **Madhya Pradesh Assembly Building**, **Mahatma Gandhi Memorial Museum** in Ahmedabad.





Cidade de Goa



Jawahar Kala Kendra, Jaipur



Some of Gandhi Smarak Sangrahalaya's modular buildings

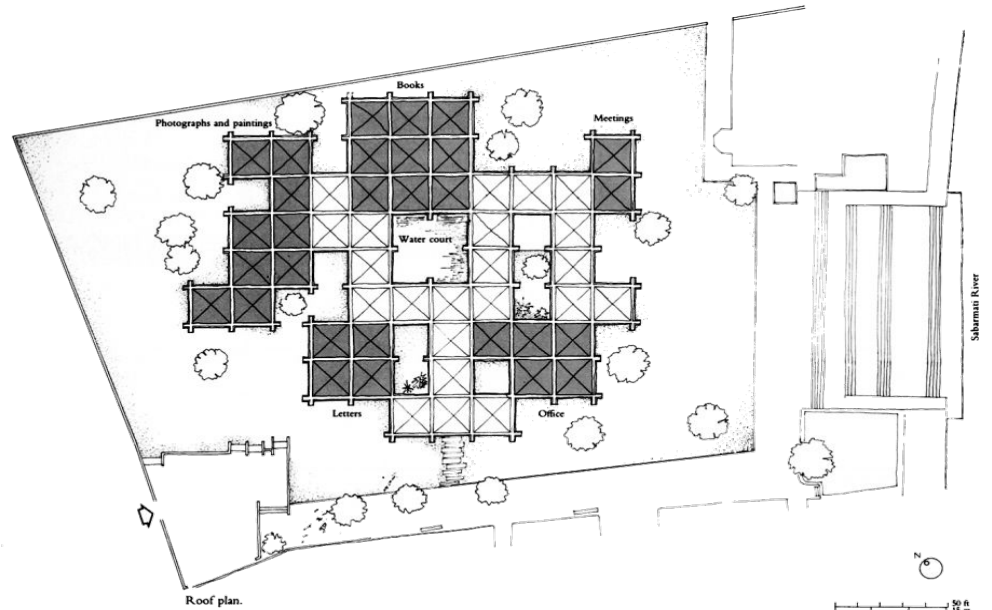
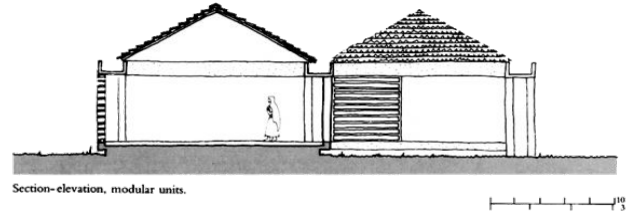

Plan of Gandhi Museum, Ahmedabad

BV Doshi

Pritzker Prize 2018 - First Indian

- He is considered an important figure of South Asian architecture, and his work is known as an essential gauge of Asian identity in the global milieu.
- He is known for contributions to the evolution of architectural discourse in India.
- He is known for his contributions to the architecture of **Indian Institute of Management Bangalore.**
- He is also known for a peculiar design of the **Amdavad ni Gufa in Ahmedabad.**
 - Amdavad ni Gufa is an underground art gallery, which exhibits works Maqbool Fida Hussain.
 - It is a cave-like underground structure whose roof is made of multiple interconnected domes, covered with a mosaic of tiles. On the inside, irregular tree-like columns support the domes.
- He was awarded by Padma Shri, Padma Bhushan, Aga Khan Award and Pritzker Prize.
- His works are known for his preference of exposed materials and subdued natural tones.

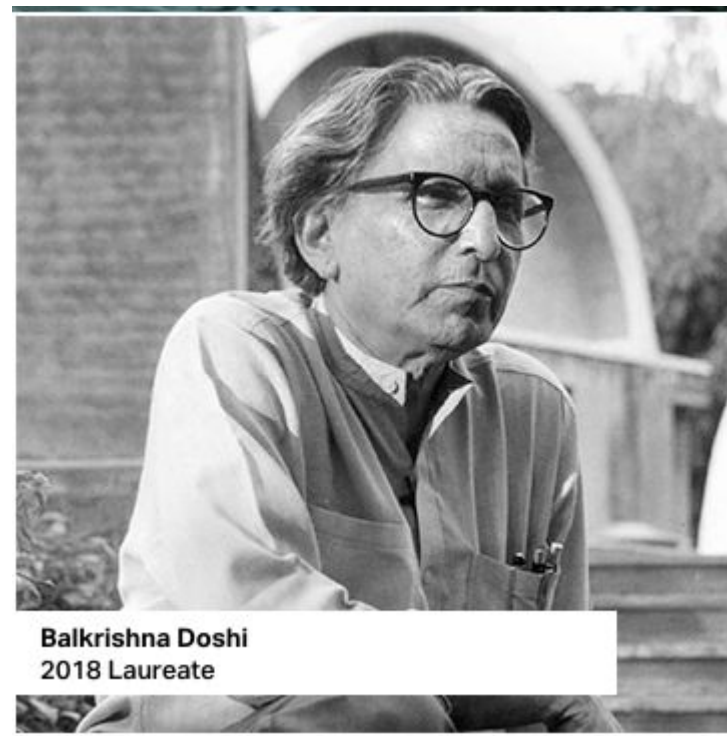

Balkrishna Doshi
2018 Laureate



- Husain-Doshi Gufa, Ahmedabad
- Inside the structure

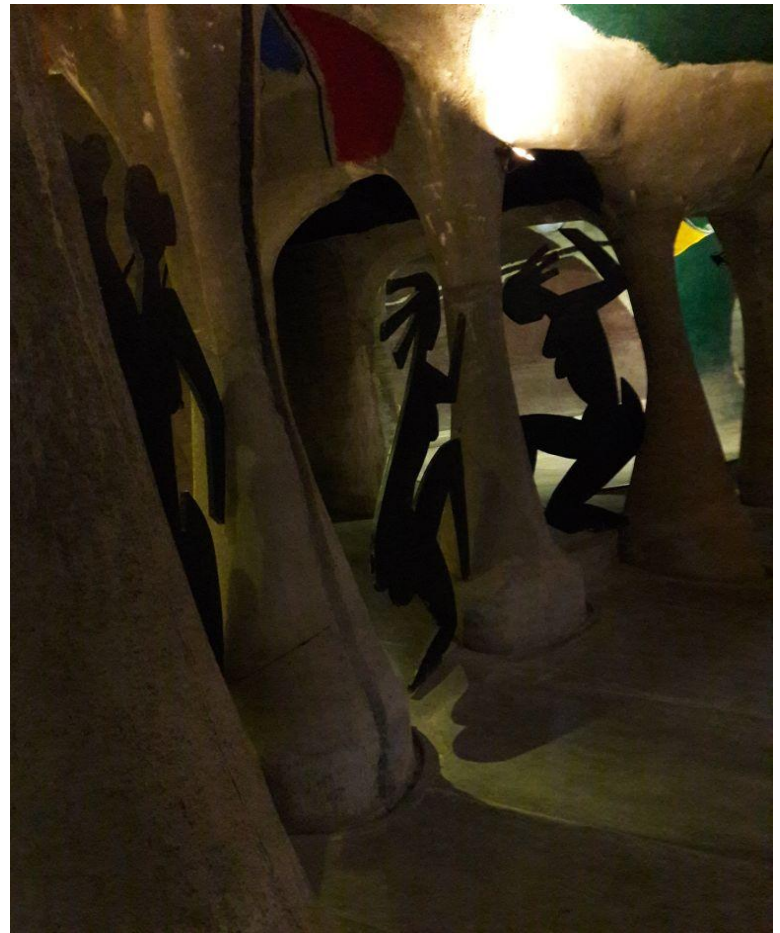



Library Block of IIM-Bangalore

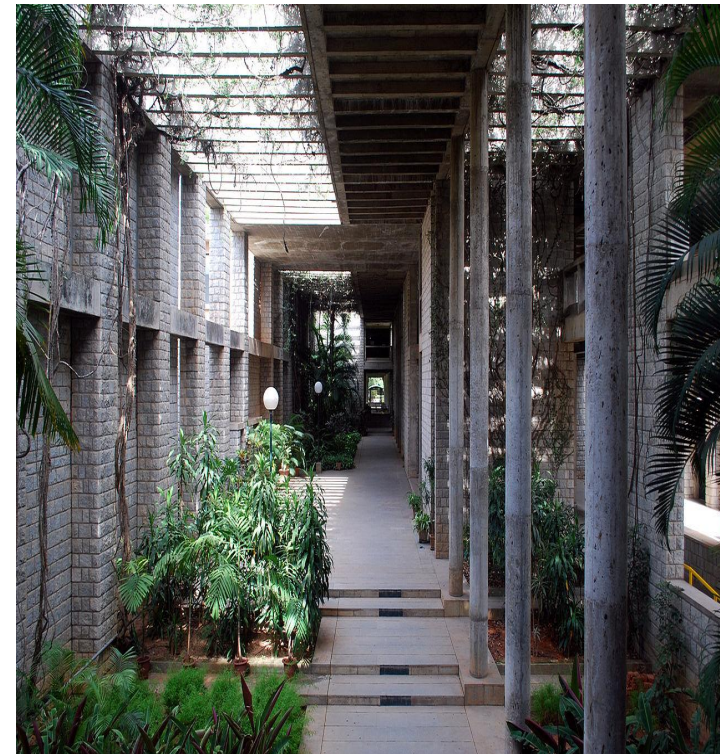

Academic Block of IIM-Bangalore

Central Vista Redevelopment Project

- It refers to the ongoing redevelopment to revamp the Central Vista, India's central administrative area located near Raisina Hill, New Delhi.
- The area was designed by Sir Edwin Lutyens and Sir Herbert Baker during British colonial rule and was retained by Government of India after independence.
- It aims to revamp
 - a 3 km long Rajpath between Rashtrapati Bhavan and India Gate.
 - Convert North and South Blocks to publicly accessible museums by creating a new common Central Secretariat to house all ministries.
 - A new Parliament building near the present one with increased seating capacity for future expansion.
 - New residence and office for the Vice-President and the Prime Minister near the North Block and South Block and convert some of the older structures into museums.

THE BLUEPRINT

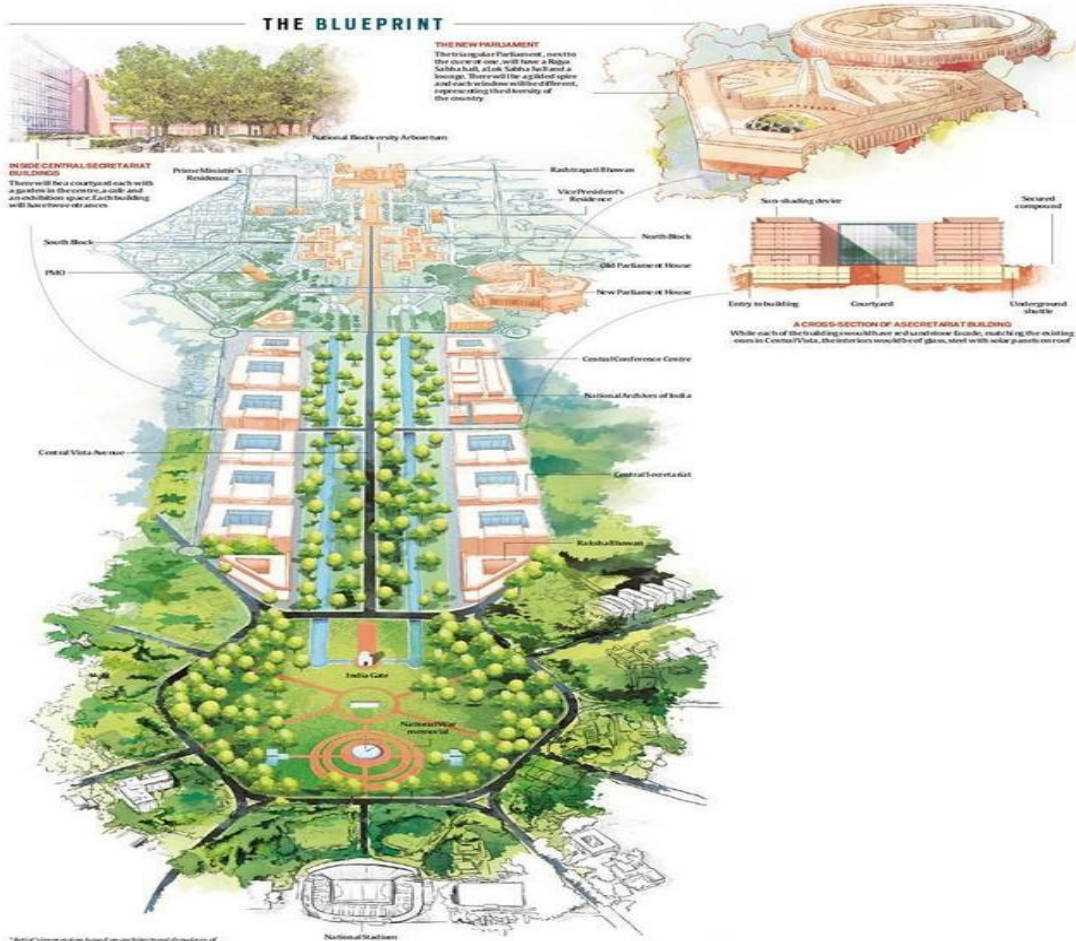

*Art of Impression based on architectural drawings of what the new Central Vista would look like
Illustration: Suvojit Dey

Illustration explaining the proposed redevelopment at Central Vista

MODERN CONTEMPORARY ARCHITECTURE OF INDIA

The era of contemporary architecture is said to have started from the beginning of 1960s. This modern movement continued till late 1990s, making the buildings in the late 20th century to the present time fall under the category of modern contemporary architecture. Some of the stunning modern architecture of India are

The British Council, New Delhi

- It's design is the collaboration of the mastermind architects **Charles Correa, Howard Hodgkin and Mahendra Raj.**
- **It was completed in 1992**
- This institution offered a massive library, audio books and internet stations.
- This building features a 180 people auditorium with state-of-the-art amenities and Mr. Correa has designed three courtyards that symbolizes three focal points that stands for the world center in Hindu, Muslim, and European cultures.

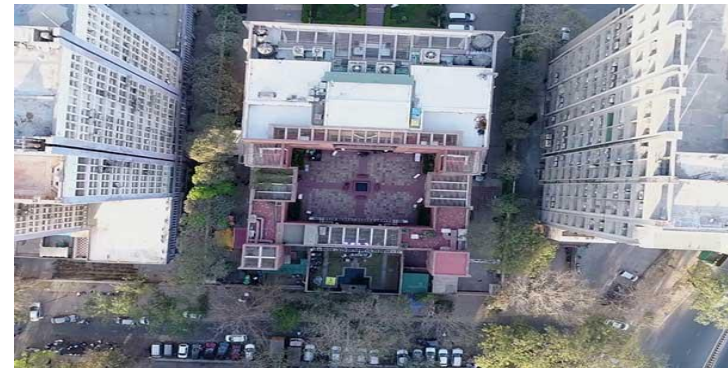
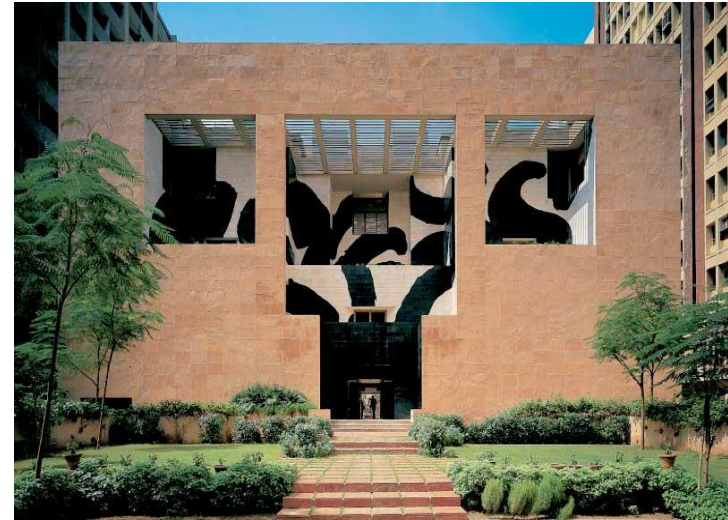

Chhatrapati Shivaji International Airport, Mumbai, Maharashtra

- It's structure is inspired by the form of traditional Indian pavilions.
- It's construction was started in 2006.
- It is designed by the architect trifecta Skidmore, Owings and Merrill (SOM)
- The architects took the **inspiration from the Indian national bird Peacock** while designing this one of a kind a structure.
- The design of the interiors has **mushroom columns** that holds a vast canopy at the second terminal of the airport.
- The architect has divided the interiors wisely to disperse the people and make the place less crowded.
- From the hinged coffered treatment on the head house columns and roof surfaces to the intricate 'jaali' windows, the Chhatrapati Shivaji International Airport is a perfect example of the **mix of traditional and modern architecture.**



Pearl Academy of Fashion, Jaipur, Rajasthan

- It is designed with traditional and modern styles while, keeping in mind the energy efficiency aspect as well.
- Exceptional features of this campus is beautiful curves inside and outside.
- Designed by the architect duo **Manit Rastogi and Sonali Rastogi**, the building is designed in such a way that, it can withstand the scorching hot climate of Jaipur.
- The structure is the inclusion of Rajasthani Jaalis with a drip system.



Residence on Pali Hill, Mumbai, Maharashtra

- It is designed by the architect company Studio Mumbai, this residence is one of the finest examples of the nature plus concrete combo.
- The internal structure is protected by layers of glass, wooden screens, planted trellises and curtains for supreme privacy amidst the urban jungle.
- The architects have used the available greenery wisely in this project.
- The polished limestone floors and pigmented lime-colored walls provides a warm welcome.
- The house is discovered through floating staircases that bestow some staggering views.



KYMF Clinic, Bengaluru, Karnataka

- It is a 30-bed dialysis center built by the Cadence architecture.
- It is renowned for its architectural presence and religious value.
- This structure is built around a temple, which is considered as the protagonist of this whole design.
- The facade of this building is made with surfaces built on rock, and the slivers between the shells allow the light to penetrate through the building to create a pleasing visual and divinity.

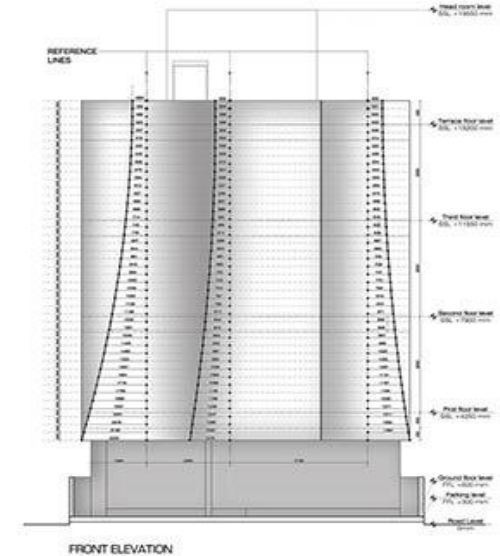
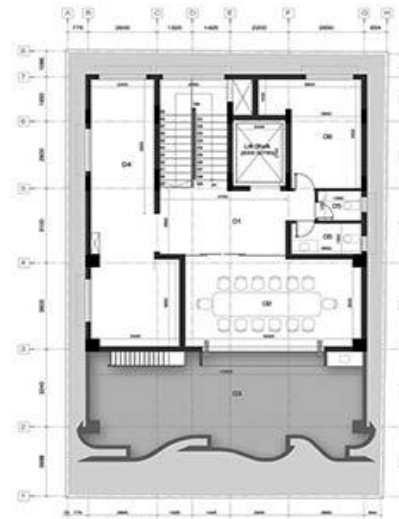

The Park Hotel, Hyderabad, Telangana

- It's architect are architects are Skidmore, Owings and Merrill (SOM).
- It offers 270 premium rooms is known for its modern and sustainable design that combines local craft and traditions.
- The design is inspired from the region's reputation as the producer of **textiles and gemstones.**
- The subtle details and the curves are made for a **sustainable and environment friendly** structure.
- The **shape of the facade** openings and the three-dimensional pattern offered in the building, the **design is inspired from the forms of metalwork of the crown jewels of the city's ancient ruling dynasty, the Nizam.**



The Light Box Restroom, Mumbai, Maharashtra

- This structure is made up of four blocks with one end containing two toilets with a common washbasin and the other end has a nursing room and a toilet for the senior citizen and handicapped.
- It is designed by Indian architect **Rohan Chavan**.
- The structure is designed around a large tree to provide natural air conditioning.
- It also included transparent roof and side covers to protect it from the nature, thus giving it the name, the Light Box.

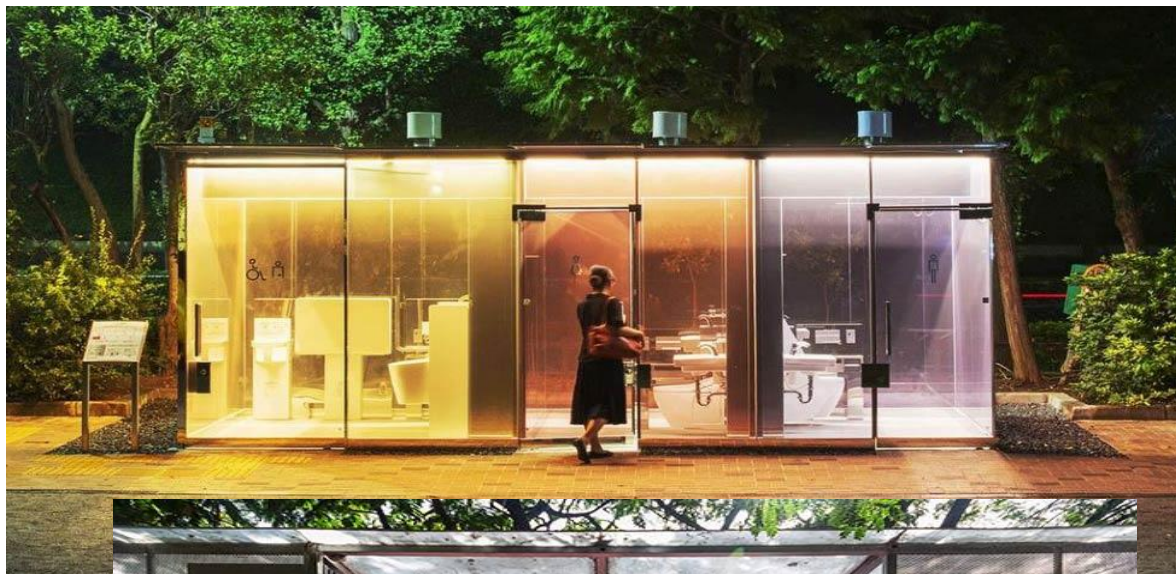

Previous years question (Prelims)

Q) Consider the following statements (2021)

- 1) St. Francis Xavier was one of the founding members of the Jesuit Order.
- 2) St. Francis Xavier died in Goa and a church is dedicated to him there.
- 3) The Feast of St. Francis Xavier is celebrated in Goa each year.

Which of the statements given above are correct? 2021

- a) 1 and 2 Only
- b) 2 and 3 Only
- c) 1 and 3 Only
- d) 1, 2 and 3

Solution

- C

Statement 1 is correct. St. Francis Xavier was one of the founders of the Jesuit order. He was a Spanish saint.

Statement 2 is incorrect. He died on the island of Sancian (now Shang-ch'uan Tao, off the Chinese coast) while trying to gain entrance to China, which was then closed to foreigners.

Statement 3 is correct. Every year the feast of St. Francis Xavier is celebrated in Goa on 3rd of December.

Previous years question (Mains)

**Q) Why is Laurie Baker called 'the conscience keeper of Indian architecture'?
(2012)**